



SUMITOMO ELECTRIC

T-25e Hand Held Fusion Splicer

T-25eS

Fibre holders: single fibres
Lynx CustomFit™ Connector compatible

T-25eS-LC

Universal coating clamp for 250um,
tight & loose buffer 900um fibres

T-25eM

Fibre holders: single & ribbon fibres
Lynx CustomFit™ Connector compatible



Highlights

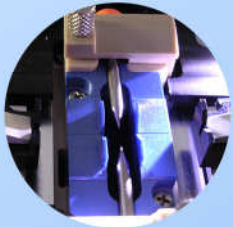

A bright white LED
lights the v-grooves



Optional WT-25 body
mount work table



Built in battery
charger



Tilt the display to
reduce glare



-LC clamps for 250um
primary & 900um
tight & loose buffer



Terminate fibres with
the Lynx CustomFit™
Splice-On Connector

Specification

	T-25eM	T-25eS	T-25eS-LC
FIBRE TYPES SPLICED	SM (ITU-T G652), MM (G651), DS (G653), PS (G654), NZ (G655 & G656) and BI (G657) fibres		
MEAN INSERTION LOSS*	SM 0.05dB, MM 0.03dB, DS 0.08dB, NZ 0.08dB		
FIBRE COUNT	1, 2 & 4	1	1
FIBRE DIAMETER	125um Cladding diameter		
COATING DIAMETER	250um primary, 900um tight buffer secondary	& 900um loose buffer	
SPLICE TIME	11s single fibre 15s 4 core ribbon	11s	11s
PROOF TEST	1.96N (200gf)		
HEAT SHRINK TIME	~40s on sleeve for 4 core ribbon	<40s 40mm sleeve <50s 60mm sleeve	<40s 40mm sleeve <50s 60mm sleeve
CLEAVE LENGTH	10mm	10mm	10mm except 20mm on 900um loose buffer
PROGRAMS	15 splice programs, 15 heat shrink oven programs		
DATA STORAGE	1500 splices		
OPERATING CONDITIONS	-10°C to 50°C, <95% non-condensing humidity, 3600m, 15m/s wind		
STORAGE CONDITIONS	-40°C to 70°C, <95% non-condensing humidity		
INTERFACES	Data: USB1.1 Type B. Power output: 12V DC for heated stripping tool		
POWER INPUTS	100~240V AC via ADC1240 adaptor or from internal BU-25 Li-ion battery		
SPLICE LYNX CONNECTOR	Yes	Yes	No
FIBRE HANDLING	Fibre holders	Fibre holders	Coating clamps
BATTERY	BU-25 2 Amp.hour Li-ion. Approx 60 splice & heat shrink cycles at 25°C		
DIMENSIONS	120(w) x 145(d) x 160(h)mm, 2.5" LCD, 1.35kg excluding BU-25 battery		
*SPLICING CONDITIONS	Insertion loss specifications given are for break and remake of identical Sumitomo fibres. Please contact Sumitomo for values applicable to other fibre combinations		

Options & accessories



ER-10



Holders for
eS & eM



BU-25

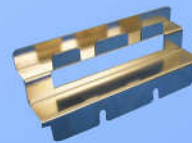

FCT-25

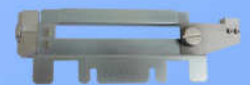

FCT-Lynx



FC-6 cleaver



FC-7 cleaver



BC-25A



CCS-25